

## SERVICE SOLUTIONS // HOW TO

# HOW TO CHANGE THE BLADE ON YOUR AIRA RBO BELLY AND BREAST OPENER

1. Dismantle the center screw (89)
2. Hold the sawblade (100) and remove the disc centering (42)
3. Pull out the sawblade by pulling gently downwards
4. Loosen the screws (90) and ensure that there still is little movement on the bearing support (43) as this is very important to secure a proper disc centering (42)
5. Mount the new sawblade (100)
6. Re-assemble the disc centering (42)  
**IMPORTANT:** The direction pin in the disc needs to enter one of the three centering holes in the center of the blade, marked with yellow
7. Start with assembling the screw in the center of the disc (89)
8. Tighten the screws (90) of the bearing support (43) to ensure the disc is properly centered again

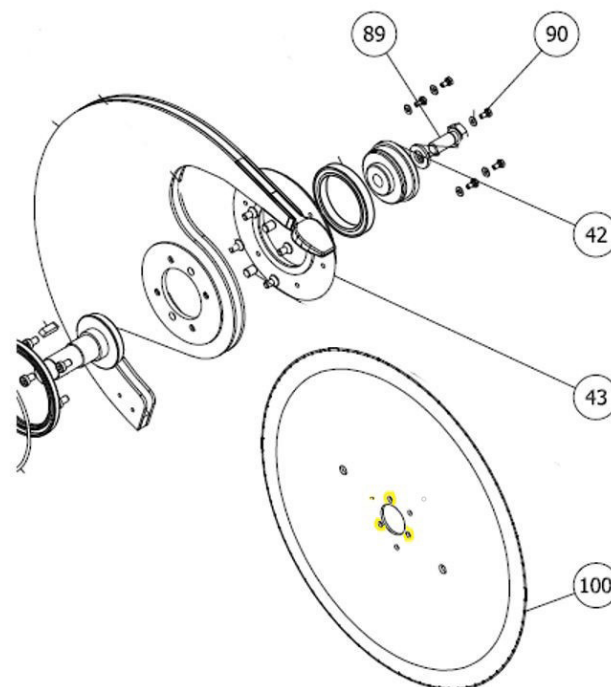

## CONTACT

Central/Eastern Europe  
+49 252 185 070  
service.de@frontmatec.com

Northern Europe, Kolding  
+45 36 999 099  
service.kol.dk@frontmatec.com

Northern Europe, Tandslet  
+45 74 407 644  
service.tan.dk@frontmatec.com

Southern Europe  
+34 932 643 800  
service.es@frontmatec.com

Western Europe  
+31 886 294 000  
service.nl@frontmatec.com